

* required information

Section 1 of 18

You can save the form at any time and resume it later. You do not need to be logged in when you resume.

System reference This is the unique reference for this application generated by the system.

Your reference You can put what you want here to help you track applications if you make lots of them. It is passed to the authority.

Are you an agent acting on behalf of the applicant?

☒ Yes ☐ No

Put "no" if you are applying on your own behalf or on behalf of a business you own or work for.

Applicant Details

* First name

* Family name

* E-mail

Main telephone number Include country code.

Other telephone number

☐ Indicate here if the applicant would prefer not to be contacted by telephone

Is the applicant:

☒ Applying as a business or organisation, including as a sole trader

☐ Applying as an individual

A sole trader is a business owned by one person without any special legal structure. Applying as an individual means the applicant is applying so the applicant can be employed, or for some other personal reason, such as following a hobby.

Applicant Business

Is the applicant's business registered in the UK with Companies House? ☒ Yes ☐ No

Note: completing the Applicant Business section is optional in this form.

Registration number

Business name If the applicant's business is registered, use its registered name.

VAT number Put "none" if the applicant is not registered for VAT.

Legal status

Continued from previous page...

Applicant's position in the business

Home country

The country where the applicant's headquarters are.

Registered Address

Address registered with Companies House.

Building number or name

Street

District

City or town

County or administrative area

Postcode

Country

Agent Details

* First name

* Family name

* E-mail

Main telephone number

Include country code.

Other telephone number

☐ Indicate here if you would prefer not to be contacted by telephone

Are you:

- ☒ An agent that is a business or organisation, including a sole trader
☐ A private individual acting as an agent

A sole trader is a business owned by one person without any special legal structure.

Agent Business

Is your business registered in the UK with Companies House? ☒ Yes ☐ No

Note: completing the Applicant Business section is optional in this form.

Registration number

Business name

If your business is registered, use its registered name.

VAT number

Put "none" if you are not registered for VAT.

Legal status

Continued from previous page...

Your position in the business

Home country

The country where the headquarters of your business is located.

Agent Registered Address

Address registered with Companies House.

Building number or name

Street

District

City or town

County or administrative area

Postcode

Country

Section 2 of 18

APPLICATION DETAILS

This application cannot be used to vary the licence so as to extend the period for which the licence has effect or to vary substantially the premises to which it relates. If you wish to make that type of change to the premises licence, you should make a new premises licence application under section 17 of the Licensing Act 2003.

I/we, as named in section 1, being the premises licence holder, apply to vary a premises licence under section 34 of the Licensing Act 2003 for the premises described in section 2 below.

* Premises Licence Number

Are you able to provide a postal address, OS map reference or description of the premises?

☒ Address ☐ OS map reference ☐ Description

Postal Address Of Premises

Building number or name

Street

District

City or town

County or administrative area

Postcode

Country

Premises Contact Details

Telephone number

Continued from previous page...

Non-domestic rateable
value of premises (£)

32,750

Section 3 of 18

VARIATION

Do you want the proposed
variation to have effect as
soon as possible?

☒ Yes

☐ No

Do you want the proposed variation to have effect in relation to the
introduction of the late night levy?

☐ Yes

☒ No

You do not have to pay a fee if the only
purpose of the variation for which you are
applying is to avoid becoming liable to the
late night levy.

If your proposed variation
would mean that 5,000 or
more people are expected to
attend the premises at any
one time, state the number
expected to attend

Describe Briefly The Nature Of The Proposed Variation

Describe the premises. For example the type of premises, its general situation and layout and any other information which could be relevant to the licensing objectives. Where your application includes off-supplies of alcohol and you intend to provide a place for consumption of these off-supplies, you must include a description of where the place will be and its proximity to the premises.

The layout of the premises is to be varied in accordance with submitted plans, the effect of which will be to create a function suite at the premises. In addition the licensed area will encompass an outside area. There are some internal changes to the premises as well, as a result of a refurbishment. The hours for licensable activities for the function suite will be extended to midnight for a half past close.

Section 4 of 18

PROVISION OF PLAYS

See guidance on regulated entertainment

Will the schedule to provide plays be subject to change if this application to
vary is successful?

☐ Yes

☒ No

Section 5 of 18

PROVISION OF FILMS

See guidance on regulated entertainment

Will the schedule to provide films be subject to change if this application to
vary is successful?

☒ Yes

☐ No

Standard Days And Timings

Continued from previous page...

MONDAY

Start 10:00

End 00:30

Start

End

Provide timings in 24 hour clock (e.g., 16:00) and only give details for the days of the week when you intend the premises to be used for the activity.

TUESDAY

Start 10:00

End 00:30

Start

End

WEDNESDAY

Start 10:00

End 00:30

Start

End

THURSDAY

Start 10:00

End 00:30

Start

End

FRIDAY

Start 10:00

End 00:30

Start

End

SATURDAY

Start 10:00

End 00:30

Start

End

SUNDAY

Start 10:00

End 00:30

Start

End

Will the exhibition of films take place indoors or outdoors or both?

☐ Indoors ☐ Outdoors ☒ Both

Where taking place in a building or other structure select as appropriate. Indoors may include a tent.

State type of activity to be authorised, if not already stated, and give relevant further details, for example (but not exclusively) whether or not music will be amplified or unamplified.

Predominantly for inside the premises, but with the flexibility to show films outside.

State any seasonal variations for the exhibition of film.

For example (but not exclusively) where the activity will occur on additional days during the summer months.

Continued from previous page...

Non standard timings. Where the premises will be used for the exhibition of film at different times from those listed above, list below.

For example (but not exclusively), where you wish the activity to go on longer on a particular day e.g. Christmas Eve.

From the end of permitted hours on New Years Eve to the start of permitted hours on New Years Day (indoors only)

Section 6 of 18

PROVISION OF INDOOR SPORTING EVENTS

See guidance on regulated entertainment

Will the schedule to provide indoor sporting events be subject to change if this application to vary is successful?

☐ Yes ☒ No

Section 7 of 18

PROVISION OF BOXING OR WRESTLING ENTERTAINMENTS

See guidance on regulated entertainment

Will the schedule to provide boxing or wrestling entertainments be subject to change if this application to vary is successful?

☐ Yes ☒ No

Section 8 of 18

PROVISION OF LIVE MUSIC

See guidance on regulated entertainment

Will the schedule to provide live music be subject to change if this application to vary is successful?

☒ Yes ☐ No

Standard Days And Timings

MONDAY

Start

End

Start

End

TUESDAY

Start

End

Start

End

WEDNESDAY

Start

End

Start

End

Provide timings in 24 hour clock (e.g., 16:00) and only give details for the days of the week when you intend the premises to be used for the activity.

Continued from previous page...

THURSDAY

Start

End

Start

End

FRIDAY

Start

End

Start

End

SATURDAY

Start

End

Start

End

SUNDAY

Start

End

Start

End

Will the performance of live music take place indoors or outdoors or both?

☐ Indoors

☐ Outdoors

☒ Both

Where taking place in a building or other structure select as appropriate. Indoors may include a tent.

State type of activity to be authorised, if not already stated, and give relevant further details, for example (but not exclusively) whether or not music will be amplified or unamplified.

Hours for music to be played outdoors will be restricted to 21:00

State any seasonal variations for the performance of live music

For example (but not exclusively) where the activity will occur on additional days during the summer months.

Non-standard timings. Where the premises will be used for the performance of live music at different times from those listed, above below.

For example (but not exclusively), where you wish the activity to go on longer on a particular day e.g. Christmas Eve.

Section 9 of 18

PROVISION OF RECORDED MUSIC

See guidance on regulated entertainment

Continued from previous page...

Will the schedule to provide recorded music be subject to change if this application to vary is successful?

☒ Yes ☐ No

Standard Days And Timings

MONDAY

Start 10:00

End 00:00

Start

End

Provide timings in 24 hour clock (e.g., 16:00) and only give details for the days of the week when you intend the premises to be used for the activity.

TUESDAY

Start 10:00

End 00:00

Start

End

WEDNESDAY

Start 10:00

End 00:00

Start

End

THURSDAY

Start 10:00

End 00:00

Start

End

FRIDAY

Start 10:00

End 00:00

Start

End

SATURDAY

Start 10:00

End 00:00

Start

End

SUNDAY

Start 10:00

End 00:00

Start

End

Will the playing of recorded music take place indoors or outdoors or both?

☐ Indoors ☐ Outdoors ☒ Both

Where taking place in a building or other structure select as appropriate. Indoors may include a tent.

State type of activity to be authorised, if not already stated, and give relevant further details, for example (but not exclusively) whether or not music will be amplified or unamplified.

Music played outside (other than background music) will not take place after 21:00

State any seasonal variations for playing recorded music.

Continued from previous page...

For example (but not exclusively) where the activity will occur on additional days during the summer months,

Non-standard timings. Where the premises will be used for the playing of recorded music at different times from those listed above, list below.

For example (but not exclusively), where you wish the activity to go on longer on a particular day e.g. Christmas Eve.

Section 10 of 18

PROVISION OF PERFORMANCES OF DANCE

See guidance on regulated entertainment

Will the schedule to provide performances of dance be subject to change if this application to vary is successful?

☐ Yes ☒ No

Section 11 of 18

PROVISION OF ANYTHING OF A SIMILAR DESCRIPTION TO LIVE MUSIC, RECORDED MUSIC OR PERFORMANCES OF DANCE

See guidance on regulated entertainment

Will the schedule to provide anything similar to live music, recorded music or performances of dance be subject to change if this application to vary is successful?

☒ Yes ☐ No

Standard Days And Timings

MONDAY

Start

End

Start

End

TUESDAY

Start

End

Start

End

WEDNESDAY

Start

End

Start

End

Provide timings in 24 hour clock (e.g., 16:00) and only give details for the days of the week when you intend the premises to be used for the activity.

Continued from previous page...

THURSDAY

Start 10:00

End 00:00

Start

End

FRIDAY

Start 10:00

End 00:00

Start

End

SATURDAY

Start 10:00

End 00:00

Start

End

SUNDAY

Start 10:00

End 00:00

Start

End

Provide a description of the type of entertainment that will be provided.

Anything not otherwise covered.

Will this entertainment take place indoors or outdoors or both?

☐ Indoors

☐ Outdoors

☒ Both

Where taking place in a building or other structure select as appropriate. Indoors may include a tent.

State type of activity to be authorised, if not already stated, and give relevant further details, for example (but not exclusively) whether or not music will be amplified or unamplified.

State any seasonal variations for entertainment.

For example (but not exclusively) where the activity will occur on additional days during the summer months.

Non-standard timings. Where the premises will be used for entertainment at different times from those listed above, list below.

For example (but not exclusively), where you wish the activity to go on longer on a particular day e.g. Christmas Eve.

Continued from previous page...

Section 12 of 18

PROVISION OF LATE NIGHT REFRESHMENT

Will the schedule to provide late night refreshment be subject to change if this application to vary is successful?

☒ Yes ☐ No

Standard Days And Timings

MONDAY

Start

End

Start

End

Provide timings in 24 hour clock (e.g., 16:00) and only give details for the days of the week when you intend the premises to be used for the activity.

TUESDAY

Start

End

Start

End

WEDNESDAY

Start

End

Start

End

THURSDAY

Start

End

Start

End

FRIDAY

Start

End

Start

End

SATURDAY

Start

End

Start

End

SUNDAY

Start

End

Start

End

Will the provision of late night refreshment take place indoors or outdoors or both?

☐ Indoors ☐ Outdoors ☒ Both

Where taking place in a building or other structure select as appropriate. Indoors may include a tent.

Continued from previous page...

State type of activity to be authorised, if not already stated, and give relevant further details, for example (but not exclusively) whether or not music will be amplified or unamplified.

It might include hot food and drinks (more likley drinks such as coffee) inside the building and in the outside area.

State any seasonal variations.

For example (but not exclusively) where the activity will occur on additional days during the summer months.

Non standard timings. Where the premises will be used for the provision of late night refreshment at different times from those listed above, list below.

For example (but not exclusively), where you wish the activity to go on longer on a particular day e.g. Christmas Eve.

Section 13 of 18

SUPPLY OF ALCOHOL

Will the schedule to supply alcohol be subject to change if this application to vary is successful?

☒ Yes

☐ No

Standard Days And Timings

MONDAY

Start

End

Start

End

Provide timings in 24 hour clock (e.g., 16:00) and only give details for the days of the week when you intend the premises to be used for the activity.

TUESDAY

Start

End

Start

End

WEDNESDAY

Start

End

Start

End

THURSDAY

Start

End

Start

End

Continued from previous page...

FRIDAY

Start 10:00

End 00:00

Start

End

SATURDAY

Start 10:00

End 00:00

Start

End

SUNDAY

Start 10:00

End 00:00

Start

End

Will the sale of alcohol be for consumption?

☐ On the premises ☐ Off the premises ☒ Both

If the sale of alcohol is for consumption on the premises select on, if the sale of alcohol is for consumption away from the premises select off. If the sale of alcohol is for consumption on the premises and away from the premises select both.

State any seasonal variations.

For example (but not exclusively) where the activity will occur on additional days during the summer months.

Non-standard timings. Where the premises will be used for the supply of alcohol at different times from those listed above, list below.

For example (but not exclusively), where you wish the activity to go on longer on a particular day e.g. Christmas Eve.

Section 14 of 18

ADULT ENTERTAINMENT

Highlight any adult entertainment or services, activities, or other entertainment or matters ancillary to the use of the premises that may give rise to concern in respect of children.

Provide information about anything intended to occur at the premises or ancillary to the use of the premises which may give rise to concern in respect of children, regardless of whether you intend children to have access to the premises, for example (but not exclusively) nudity or semi-nudity, films for restricted age groups etc gambling machines etc.

None

Continued from previous page...

Section 15 of 18

HOURS PREMISES ARE OPEN TO THE PUBLIC

Standard Days And Timings

MONDAY

Start

End

Start

End

Provide timings in 24 hour clock (e.g., 16:00) and only give details for the days of the week when you intend the premises to be used for the activity.

TUESDAY

Start

End

Start

End

WEDNESDAY

Start

End

Start

End

THURSDAY

Start

End

Start

End

FRIDAY

Start

End

Start

End

SATURDAY

Start

End

Start

End

SUNDAY

Start

End

Start

End

State any seasonal variations.

For example (but not exclusively) where the activity will occur on additional days during the summer months.

Non standard timings. Where you intend to use the premises to be open to the members and guests at different times from those listed above, list below.

For example (but not exclusively), where you wish the activity to go on longer on a particular day e.g. Christmas Eve.

Continued from previous page...

Identify those conditions currently imposed on the licence which you believe could be removed as a consequence of the proposed variation you are seeking.

- ☒ I have enclosed the premises licence
- ☐ I have enclosed the relevant part of the premises licence

Reasons why I have failed to enclose the premises licence or relevant part of premises licence.

Section 16 of 18

LICENSING OBJECTIVES

Describe the steps you intend to take to promote the four licensing objectives:

a) General – all four licensing objectives (b,c,d,e)

List here steps you will take to promote all four licensing objectives together.

Please see attached operating schedule and revised conditions to replace the existing conditions at Annex 2.

b) The prevention of crime and disorder

Please see attached operating schedule and revised conditions to replace the existing conditions at Annex 2.

c) Public safety

Please see attached operating schedule and revised conditions to replace the existing conditions at Annex 2.

d) The prevention of public nuisance

Please see attached operating schedule and revised conditions to replace the existing conditions at Annex 2.

Continued from previous page...

e) The protection of children from harm

Please see attached operating schedule and revised conditions to replace the existing conditions at Annex 2.

Section 17 of 18

NOTES ON REGULATED ENTERTAINMENT

In terms of specific **regulated entertainments** please note that:

- Plays: no licence is required for performances between 08:00 and 23.00 on any day, provided that the audience does not exceed 500.
- Films: no licence is required for 'not-for-profit' film exhibition held in community premises between 08.00 and 23.00 on any day provided that the audience does not exceed 500 and the organiser (a) gets consent to the screening from a person who is responsible for the premises; and (b) ensures that each such screening abides by age classification ratings.
- Indoor sporting events: no licence is required for performances between 08.00 and 23.00 on any day, provided that the audience does not exceed 1000.
- Boxing or Wrestling Entertainment: no licence is required for a contest, exhibition or display of Greco-Roman wrestling, or freestyle wrestling between 08.00 and 23.00 on any day, provided that the audience does not exceed 1000. Combined fighting sports – defined as a contest, exhibition or display which combines boxing or wrestling with one or more martial arts – are licensable as a boxing or wrestling entertainment rather than an indoor sporting event.
- Live music: no licence permission is required for:
 - o a performance of unamplified live music between 08.00 and 23.00 on any day, on any premises.
 - o a performance of amplified live music between 08.00 and 23.00 on any day on premises authorised to sell alcohol for consumption on those premises, provided that the audience does not exceed 500.
 - o a performance of amplified live music between 08.00 and 23.00 on any day, in a workplace that is not licensed to sell alcohol on those premises, provided that the audience does not exceed 500.
 - o a performance of amplified live music between 08.00 and 23.00 on any day, in a church hall, village hall, community hall, or other similar community premises, that is not licensed by a premises licence to sell alcohol, provided that (a) the audience does not exceed 500, and (b) the organiser gets consent for the performance from a person who is responsible for the premises.
 - o a performance of amplified live music between 08.00 and 23.00 on any day, at the non-residential premises of (i) a local authority, or (ii) a school, or (iii) a hospital, provided that (a) the audience does not exceed 500, and (b) the organiser gets consent for the performance on the relevant premises from: (i) the local authority concerned, or (ii) the school or (iii) the health care provider for the hospital.
- Recorded Music: no licence permission is required for:
 - o any playing of recorded music between 08.00 and 23.00 on any day on premises authorised to sell alcohol for consumption on those premises, provided that the audience does not exceed 500.
 - o any playing of recorded music between 08.00 and 23.00 on any day, in a church hall, village hall, community hall, or other similar community premises, that is not licensed by a premises licence to sell alcohol, provided that (a) the audience does not exceed 500, and (b) the organiser gets consent for the performance from a person who is responsible for the premises.
 - o any playing of recorded music between 08.00 and 23.00 on any day, at the non-residential premises of (i) a local authority, or (ii) a school, or (iii) a hospital, provided that (a) the audience does not exceed 500, and (b) the organiser gets consent for the performance on the relevant premises from: (i) the local authority concerned, or (ii) the school proprietor or (iii) the health care provider for the hospital.

Continued from previous page...

- Dance: no licence is required for performances between 08.00 and 23.00 on any day, provided that the audience does not exceed 500. However, a performance which amounts to adult entertainment remains licensable.
- Cross activity exemptions: no licence is required between 08.00 and 23.00 on any day, with no limit on audience size for:
 - o any entertainment taking place on the premises of the local authority where the entertainment is provided by or on behalf of the local authority;
 - o any entertainment taking place on the hospital premises of the health care provider where the entertainment is provided by or on behalf of the health care provider;
 - o any entertainment taking place on the premises of the school where the entertainment is provided by or on behalf of the school proprietor; and
 - o any entertainment (excluding films and a boxing or wrestling entertainment) taking place at a travelling circus, provided that (a) it takes place within a moveable structure that accommodates the audience, and (b) that the travelling circus has not been located on the same site for more than 28 consecutive days.

Section 18 of 18

PAYMENT DETAILS

This fee must be paid to the authority. If you complete the application online, you must pay it by debit or credit card.

Variation Fees are determined by the non-domestic rateable value of the premises.

To find out a premises non domestic rateable value go to the Valuation Office Agency site at http://www.voa.gov.uk/business_rates/index.htm

Band A - No RV to £4300 £100.00

Band B - £4301 to £33000 £190.00

Band C - £33001 to £87000 £315.00

Band D - £87001 to £125000 £450.00*

Band E - £125001 and over £635.00*

*If the premises rateable value is in Bands D or E and the premises is primarily used for the consumption of alcohol on the premises then you are required to pay a higher fee

Band D - £87001 to £125000 £900.00

Band E - £125001 and over £1,905.00

If you own a large premise you are subject to additional fees based upon the number in attendance at any one time

Capacity 5000-9999 £1,000.00

Capacity 10000 -14999 £2,000.00

Capacity 15000-19999 £4,000.00

Capacity 20000-29999 £8,000.00

Capacity 30000-39000 £16,000.00

Capacity 40000-49999 £24,000.00

Capacity 50000-59999 £32,000.00

Capacity 60000-69999 £40,000.00

Capacity 70000-79999 £48,000.00

Capacity 80000-89999 £56,000.00

Capacity 90000 and over £64,000.00

* Fee amount (£)

190.00

ATTACHMENTS

AUTHORITY POSTAL ADDRESS

Continued from previous page...

Address

Building number or name

Street

District

City or town

County or administrative area

Postcode

Country

DECLARATION

I/WE UNDERSTAND THAT IT IS AN OFFENCE, UNDER SECTION 158 OF THE LICENSING ACT 2003, TO MAKE A FALSE
* STATEMENT IN OR IN CONNECTION WITH THIS APPLICATION. THOSE WHO MAKE A FALSE STATEMENT MAY BE LIABLE ON
SUMMARY CONVICTION TO A FINE OF ANY AMOUNT.

☐ Ticking this box indicates you have read and understood the above declaration

This section should be completed by the applicant, unless you answered "Yes" to the question "Are you an agent acting on behalf of the applicant?"

* Full name

* Capacity

Date (dd/mm/yyyy)

Add another signatory

Once you're finished you need to do the following:

1. Save this form to your computer by clicking file/save as...
2. Go back to <https://www.gov.uk/apply-for-a-licence/premises-licence/gateshead/change-1> to upload this file and continue with your application.

Don't forget to make sure you have all your supporting documentation to hand.

IT IS AN OFFENCE, UNDER SECTION 158 OF THE LICENSING ACT 2003, TO MAKE A FALSE STATEMENT IN OR IN CONNECTION WITH THIS APPLICATION. THOSE WHO MAKE A FALSE STATEMENT MAY BE LIABLE ON SUMMARY CONVICTION TO A FINE OF ANY AMOUNT.



**FIRST FLOOR LAYOUT 1:100
(TO REMAIN AS EXISTING)**

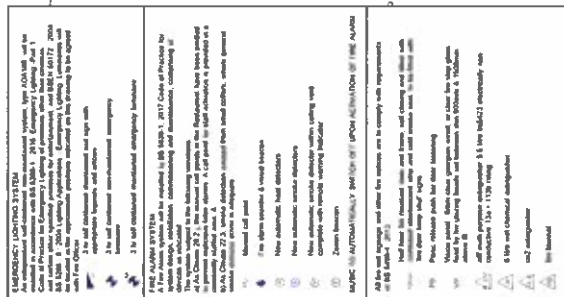

LOOSE FURNITURE SHOULD BE SECURED AND IS NOT PERMITTED TO BE

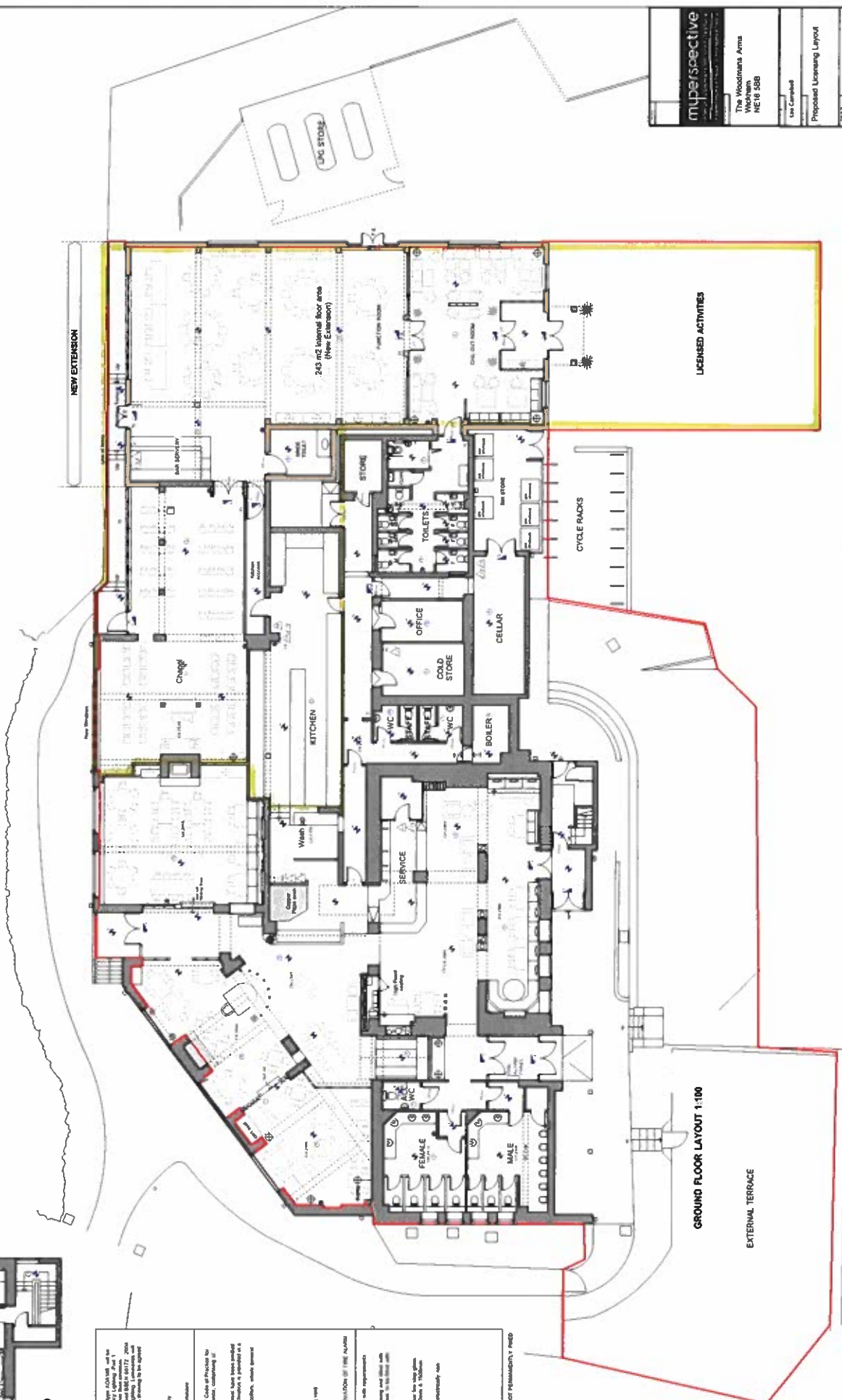

GROUND FLOOR LAYOUT 1:100

EXTERNAL TERRACE

LICENSED ACTIVITIES

The Woodsmans Arms Variation Application

Operating Schedule

An application has been made in order to vary the premises licence in accordance with submitted plans. The plans essentially create two operations within the business, one geared at weddings/functions (edged in green), and the other to remain unchanged as a food led pub. The wedding venue will also have the facilities to conduct civil ceremonies. Both will trade under the name of The Woodsman's Arms. This represents the culmination of a half million pound investment in the premises, which the operators will hope creates 25 new jobs.

An extension of 30 minutes will apply to the function suite (edged in green) for all licensable activities and opening times. This will have the effect of bringing the hours on all other days in line with those permitted on a Friday and Saturday. The hours at in the rest of the premises will remain unchanged. The applicant also seeks to add the exhibition of Film in line with the opening times for the premises.

The two trading environments will have their own respective entrances and toilet facilities. They will also both have their own outside seating areas, distinct and separate from each other.

Part of the application is also to replace the existing conditions attached to the premises licence at Annex 2 The new conditions, which are to replace all non-mandatory conditions on the licence. For the avoidance of doubt, since the current licence is a little contradictory, the premises will be licensed for on and off sales

Conditions

1. Waiter/waitress service will be available throughout the hours that premises are open.
2. The operator shall ensure that at all times when the premises are open for any licensable activity, there is sufficient, competent staff on duty at the premises for the purpose of fulfilling the terms and conditions of the licence and for preventing crime and disorder.
3. The operator and designated premises supervisor shall conduct a risk assessment for the general operation of the premises and in the case of individual bespoke events.
4. A CCTV system shall be designed, installed and maintained in proper working order, to the satisfaction of the Licensing Authority and in consultation with Northumbria Police.

Such a system shall:-

- a. be operated by properly trained staff;
 - b. be in operation at all times that the premises are being used for a licensable activity;
 - c. ensure coverage of all entrances and exits to the licensed premises internally and externally;
 - d. ensure coverage of such other areas as may be required by the Licensing Authority and Northumbria Police;
 - e. during the times licensable activities are provided, a member of management or staff will be contactable and trained in the retrieval of CCTV footage, with the ability to download the relevant footage onto a disc within a reasonable time of any request from Northumbria Police to do so;
 - f. provide continuous recording facilities for each camera during the provision of licensable activities to a good standard of clarity. Such recordings shall be retained on the hard drive or otherwise may be put on disc or otherwise (for a period of 28 days), and shall be supplied to the Licensing Authority or Police Officer on request.
5. The maximum number of persons permitted on the premises at any one time shall not exceed a figure prescribed by the risk assessment carried out by the Premises Licence Holder in accordance with fire safety legislation and will be further limited by the number of seats available
 6. An operation policy shall be implemented in respect of the management of the outside area to include staffing, noise monitoring, noise reduction/mitigation, dispersal and general management of the area on a daily basis.
 7. No glass material or bottles shall be deposited in any skip, bin or other container of a like nature, located in the open air outside of the premises between the hours of 21:00 hrs and 0800 hrs. Any such skip, bin or container shall not be removed from the premises between those hours.

8. All members of staff at the premises shall seek "credible photographic proof of age evidence" from any person who appears to be under the age of 25 years and who is seeking to purchase or consume alcohol on the premises. Such credible evidence, which shall include a photograph of the customer, will either be a passport, photographic driving licence or proof of age card carrying a "PASS" logo.
9. All food and beverage staff will undergo internal training on induction as to the requirements under the Licensing Act 2003, including underage sales and the premises proof of age policy. Such training will be documented, refreshed at least annually and available to the Police, Licensing Authority and Trading Standards upon providing reasonable notice.
10. Recorded music and live music will be permitted in the outside area abutting the function suite (edged in green) up until 21:00.